



# Habitat 2000

IMPERIAL COUNTY, CALIFORNIA



*Habitat 2000 was planned to provide a more affordable alternative to Palm Springs for seniors wanting a quality low desert recreationally oriented lifestyle. The secure community included a full complement of recreation set amidst eight distinct villages.*

Habitat 2000 was designed to be a retirement community in an area known for attracting “snowbirds”. Adjacent to the Salton Sea in the low California desert, the community was planned to be a ‘blue collar’ Palm Springs involving over 10,000 dwelling units in eight villages on 1,720 acres. Retirement communities concentrate on “lifestyles and activities.” As such, Habitat 2000 had been planned to contain a variety of community-wide and village specific activities and programs including an 18-hole championship golf course, an 18-hole executive course and a 162-acre lagoon adjacent to the Salton Sea. The concept for the lagoon was to create a body of water that buffers the community from the brackish waters of the sea while providing for new recreational opportunities (boating, swimming, picnicking, etc.) in a park-like setting. Water in the lagoon would be a mixture of fresh and brackish water. Other community features planned for Habitat 2000 includes roughly 20 acres of highway retail and a 5-acre resort hotel/spa with championship tennis facilities.

*Resort Hotel Concept*

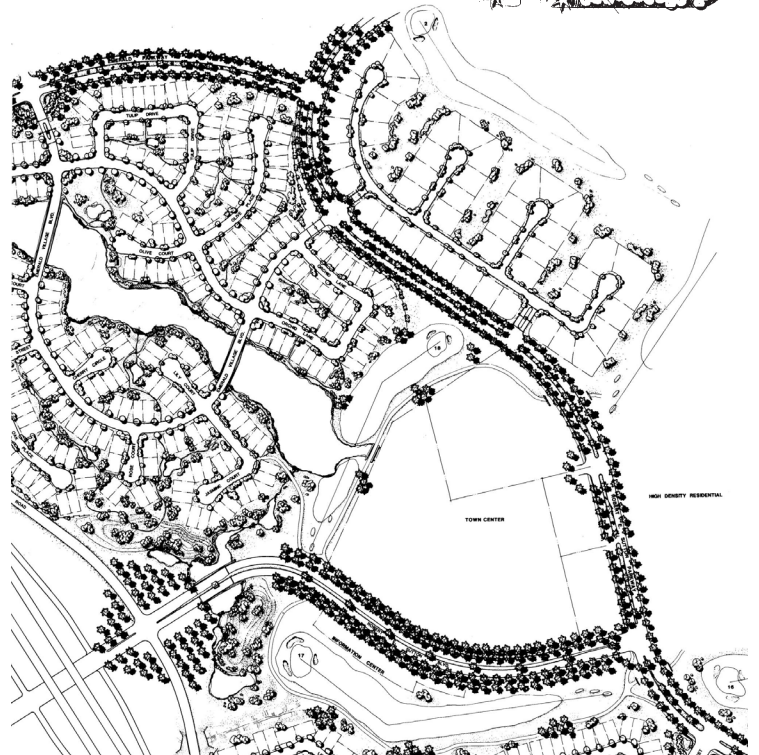
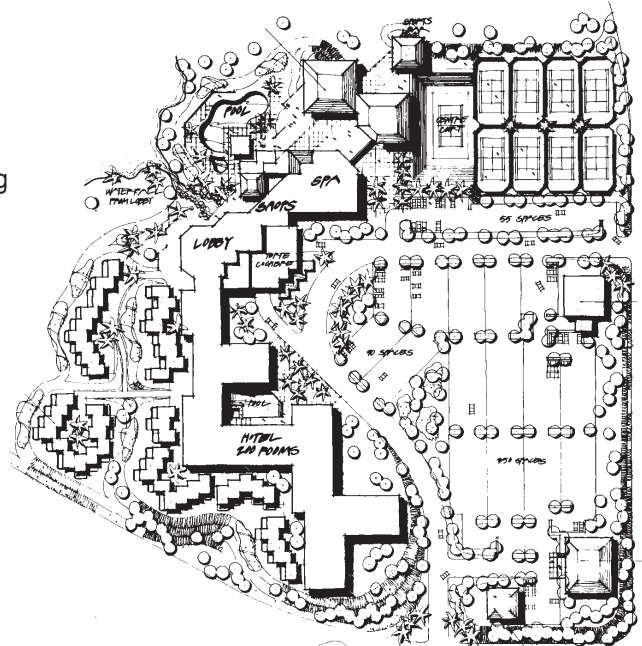

*Phase One Development*